

PREMISES NO.- 91A, DR. LAL MOHAN
BHATTACHARYYA ROAD,
KOLKATA-700014,
WARD NO.-55, BOROUGH -VI.

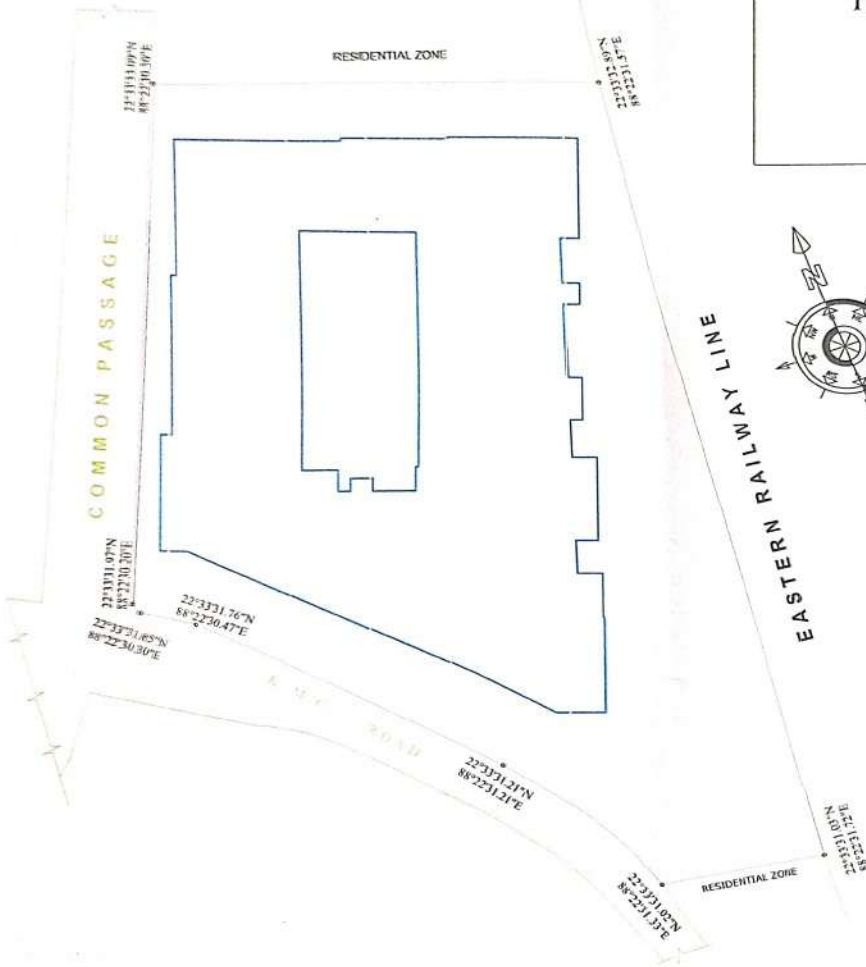

KEY PLAN

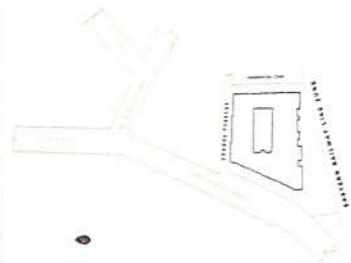

LEGEND:-

BOUNDARY LINE	---
BUILDING LINE	---
ROAD	---

NOTES:-

ALL DIMENSION ARE IN METER
OTHERWISE STATED

TOTAL AREA OF LAND=1969.435 SQ.M.
(29 IK.-07 CH.- 04 SFT)

FOR LIM REAL ESTATE PRIVATE LIMITED

Mousumi Ghosh

Director